



USER MANUAL

LG TONE Free

Bluetooth[®] LG Stereo Headset

**HBS-FN6 / HBS-FN5U /
HBS-FN4**

English	Magyar	Español
Čeština	Italiano	Slovensky
Français	Nederlands	Lietuvių
Deutsch	Polski	Latviski



Google Play



App Store

Rev 8.0 EU
www.lg.com

Using LG TONE Free™

Použití LG TONE Free™

Utilisation du LG TONE Free™

LG TONE Free™ verwenden

Az LG TONE Free™ használat

Utilizzo di LG TONE Free™

LG TONE Free™ gebruiken

Używanie LG TONE Free™

Uso de LG TONE Free™

Používanie slúchadiel LG TONE Free™

„LG TONE Free™“ naudojimas

LG TONE Free™ izmantošana

**LG Electronics Inc. Single point of contact (EU/UK) :
Krijgsman 1, 1186 DM Amstelveen, The Netherlands**

Using LG TONE Free™

Copyright © 2020 - 2021 LG Electronics Inc. All Rights Reserved

NOTE: For the best performance and to prevent any damage to, or misuse of the headset, please read all of the information carefully prior to using the headset.

Any modifications or changes to this manual due to typographical errors or inaccuracies of stated information shall only be made by LG Electronics Inc.

The LG TONE Free (HBS-FN6 / HBS-FN5U / HBS-FN4) is a lightweight wireless headset that uses *Bluetooth* technology.

This product can be used as an audio accessory for devices supporting either the A2DP or Hands-Free *Bluetooth* Profile.

Safety Cautions

CAUTION

Do not disassemble, adjust, or repair the product arbitrarily.

Do not place the product near excessive heat or flammable material.

The product may be damaged if an incompatible charger is used.

Make sure that an infant or child does not swallow a magnet or a small component of the product.

Make sure that foreign objects do not enter the charger's connectors (charging port and power plug). Failure to do so may result in fire or electric shock.

If you have a medical device implanted, contact your doctor before using this device.

This product has a built-in battery, and the battery cannot be removed or replaced arbitrarily.

For your safety, do not remove the battery incorporated in the product.

If you arbitrarily replace the battery or don't replace it correctly, it may explode.

The lithium-ion battery is a hazardous component that can cause injury.

Battery replacement by an unqualified professional can cause damage to your device.

Do not replace the battery by yourself. The battery can be damaged, which can cause overheating and injury. The battery must be replaced by an authorized service provider. The battery should be recycled or disposed separately from household wastes.

Do not discard the battery arbitrarily. Follow the local procedure for discarding batteries.

In order to prevent unnecessary energy consumption, disconnect the device when fully charged. Always use an easily accessible power outlet for charging your device.

Risk of fire or explosion if the battery is replaced by an incorrect type.

Do not store or transport at pressures lower than 11.6 kPa and at above 15,000 m altitude.

Replacement of a battery with an incorrect type that can defeat a safeguard (for example, in the case of some lithium battery types).

Disposal of a battery into fire or a hot oven, or mechanically crushing or cutting of a battery, that can result in an explosion.

Leaving a battery in an extremely high temperature surrounding environment that can result in an explosion or the leakage of flammable liquid or gas.

A battery subjected to extremely low air pressure that may result in an explosion or the leakage of flammable liquid or gas.

Do not carelessly throw away old batteries. It can cause an explosion or fire. The disposal method may vary by country and region. Dispose of it in an appropriate manner.

WARNING

Do not drop the product from a high place.

Make sure there is no water, alcohol, or benzene in contact with the product.

Do not store the product in a wet or dusty place.

Do not place heavy objects on the product.

This product is waterproof to the IPx4 level (daily life waterproof).

(The IPx4 waterproof rating applies to the earbud product only.)

Do not put the product under the water or use it in a humid location such as a bathroom.

NOTE

If the product is exposed to excessive sweat, clean the product.

Keep the earbuds clean.

HD Speaker

If the communication network of the device you are connecting to supports HD Voice Calling, you can enjoy making voice calls and listening to music in high definition.

Product Components

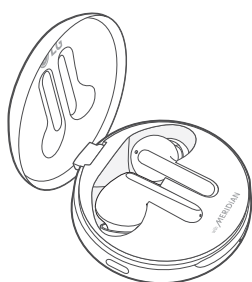

LG TONE Free™
Earbuds (medium eargels installed)
UV Charging Case (this apply to
HBS-FN6 and HBS-FN5U)

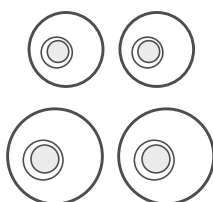

Extra Ear Gels
(small & large)

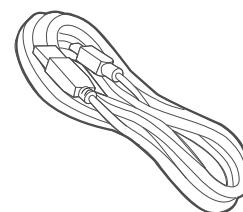

USB Type C™ Charging Cable



Reference guide

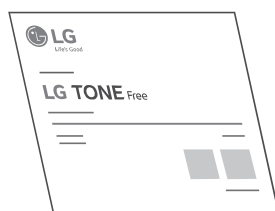

User Manual



WEEE Card (Europe Only)

NOTE: Actual product design may differ from images shown in manual.

⚠ CAUTION

Make sure authentic LG Electronics components are used. Using a non-authentic component may damage the product and thus void the warranty.

Use the USB Type C™ cable provided with the product.

Product Description

Charging Case

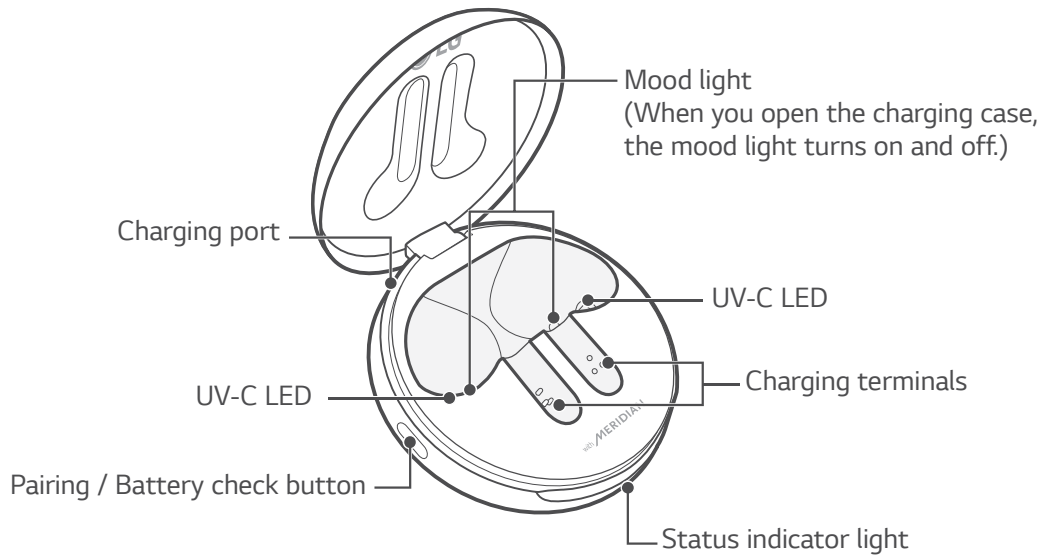

Earbuds

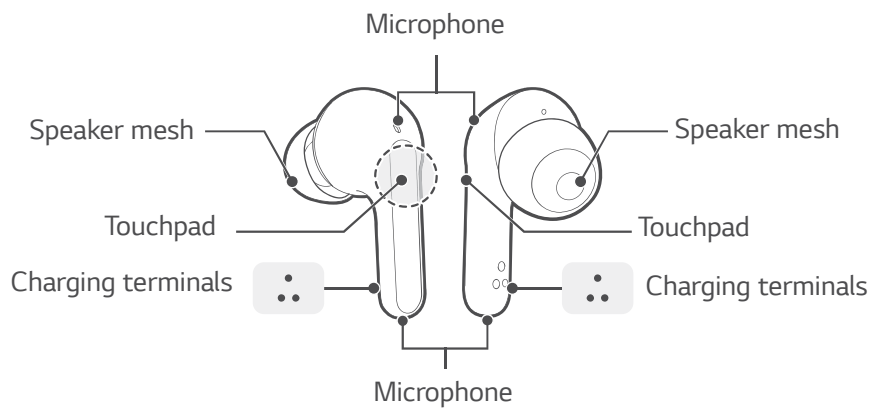

*The appearance and specifications of the actual product may differ depending on the model.

NOTE: HBS-FN4 does not have a UV-C LED and mood light.

Pairing and Connecting

Fast Pair



- 1 Activate *Bluetooth* on your phone or device.
- 2 While the earbud is mounted in the charging case, open the charging case lid and press the pairing button for 3 to 5 seconds until the blue indicator light blinks.

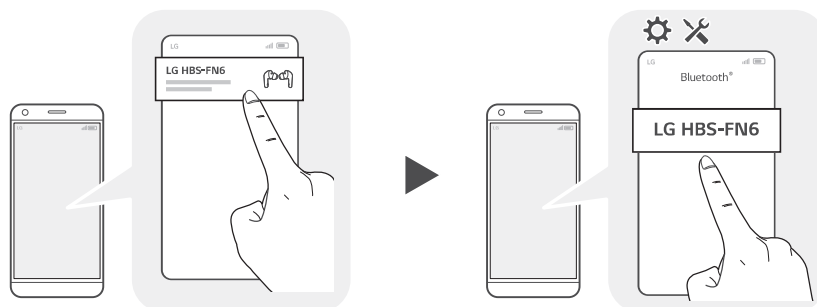

- 3 When the Fast Pair connection pop-up appears on the top area of the mobile phone screen, tap it to connect. (It only supports Android™ 6.0 or higher, and requires configuring *Bluetooth* and location information settings of the mobile device.)
- 4 If the pop-up does not appear, select **[LG HBS-FN6]** from the *Bluetooth* menu on the mobile phone and connect it (for users of iOS or Android 5.0 or lower versions).

NOTE: To connect with another device, perform the above procedure again.

CAUTION: In the list of *Bluetooth* connected devices, LG HBS-FN6_LE is not the correct model name for connection. Check the model name in use and connect with the model name without "LE".

Automatic Reconnection

The earbuds are connected automatically when you open the cover of the charging case. If you close the cover of the charging case with both earbuds mounted in the charging case, the earbuds are disconnected.

How to wear earbuds

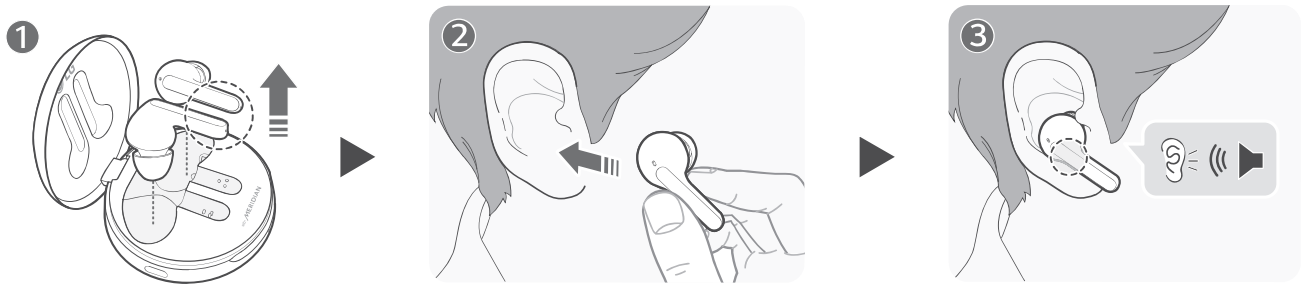

Separate the earbuds from the charging case and adjust them so that they fit comfortably in your ears. When you wear the earbuds, you will hear a wearing detection alarm.

NOTE: You can easily separate the earbuds from the charging case by turning the part with dotted line in Image 1 to left or right and lifting the earbuds.

Indicator Light

Status	Description
<i>Bluetooth</i> Search Mode	The blue status indicator light blinks.
Battery below 20%	The red status indicator light turns on and off.
Battery 20% - 80%	The purple status indicator light turns on and off.
Battery 80% or more	The blue status indicator light turns on and off.
When there is a problem while charging	The red status indicator light blinks.
When the UVnano function is operating	The status indicator light blinks slowly during the UV-C LED operation.

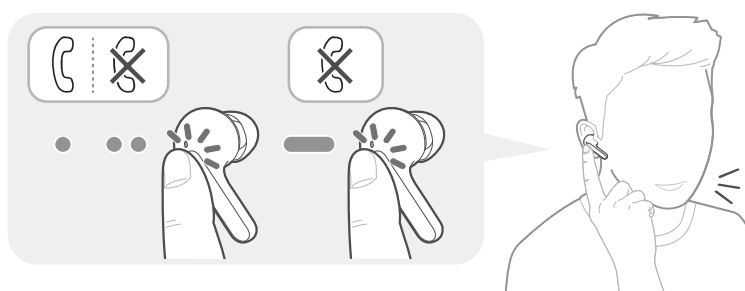

Mobile Calling Functions

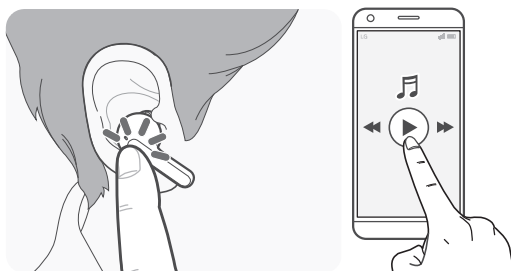

Function	Status	Description
Answering Calls	Ringing	Touch the left or right earbud once.
Ending Calls	Talking	Touch the left or right earbud twice.
Making Calls	Idle	If you make a call using a mobile phone, the call is automatically connected to the headset.
Receiving Calls while on the Phone	Talking	If you touch the left or right earbud once, the current call will go on hold, and you will be able to answer an incoming call. If the previous call is on hold, you can finish the current call on the mobile phone. (It works differently depending on the mobile phone settings.)
Rejecting Calls	Ringing	Touch and hold the left or right earbud.

Playing Music



Function	Description
Play / Pause	 : Touch the left or right earbud once.
Adjusting the Volume	 : Touch the left(Decrease volume) or right(Increase volume) earbud twice.
Play Next	 : Touch the left or right earbud three times.

NOTE: On the LG TONE Free app, you can switch the operation mode through the touchpad settings.

Listening to the ambient sound

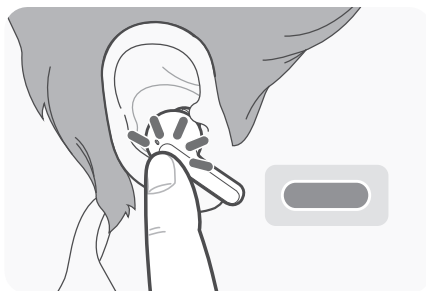

Touch and hold the left or right earbud to hear the ambient sound.

You can adjust the intensity of the ambient sound in the LG TONE Free app.

The Listen to the Ambient Sound function works only when the product is on hold or playing music.

While using the listen to the ambient sound function, the battery discharges faster than usual.

CAUTION: When the Listen to the Ambient Sound mode is enabled, you may hear the ambient sound become loud suddenly.

Battery Status

If earbuds are mounted in the charging case, the earbuds' battery status is displayed.

Otherwise, the charging case's battery status is displayed.

If the earbuds are mounted in the charging case while plugged in, the UVnano process will commence for ten minutes.

Once this process is complete, the charging case's battery status will be displayed.



Indicator Light	Battery Status
Red	Below 20% battery
Violet	Between 20% and 80% battery
Blue	Above 80% battery

NOTE: When the charging case lid is closed, charging case battery status is displayed. If the charging case has no remaining charge, there will be no display and it cannot function. We recommend you keep the charging case charged at all times as the earbuds are not able to be turned on and turned off independently.

How to charge

Wired Charging



When the charging cable is connected, the charging status is displayed in the charging case.

NOTE: The earbuds and the charging case are charged at the same time.

The charging port on the charging case cannot be used to supply power to mobile phones, etc.

Wireless Charging

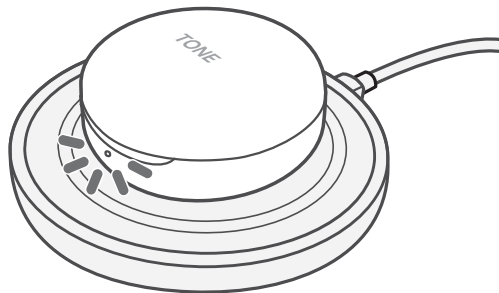

Align the bottom center of the charging case with the center of the wireless charger.

NOTE: The wireless charger is not provided. HBS-FN5U and HBS-FN4 does not support wireless charging. The wireless charging function may not work in some wireless chargers. Wireless charging feature charges at a slower rate due to less power being transmitted to the charging case.

UVnano Description

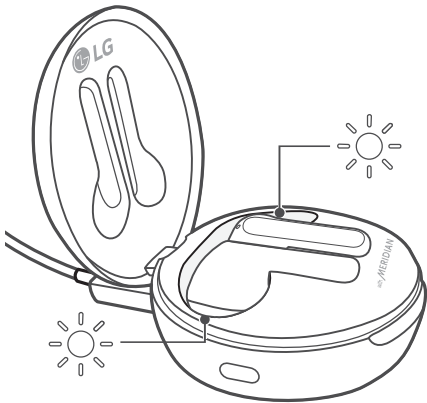

UV-C LED process operates for ten minutes and begins when charging case (with earbuds) is plugged in. UV-C LED does not operate while device is charging wirelessly such as on a pad or third party wireless charging device (this apply to HBS-FN6 and HBS-FN5U).

- Independent testing shows the UVnano charging case kills 99.9% of bacteria (*Staphylococcus aureus* and *Escherichia coli*) on the speaker mesh of the earbuds in ten minutes while charging. The UV-C LED function works only when the charging case is connected to the power cable.
- For best result, it is recommended that the full 10 minutes of UV-C LED operation be performed while charging.

NOTE: The status indicator light blinks slowly during the UV-C LED operation.

The light will slowly illuminate on and off until the UV-C LED function is complete (10 minutes). Once completed, the indicator light will switch back to the always-on battery indicator, see "Battery Status".

HBS-FN4 does not have a UV-C LED and mood light.

Performance may vary based on usage conditions.

A white product may slightly differ in the color of the UV-C LED contact area, but there is no problem with the product performance.

UV-C LED does not operate while charging wirelessly.

CAUTION: Be aware that the temperature of the earbuds may rise while the UV-C LED is operating.

Avoid direct eye and skin exposure to UV light.

Keep out of reach of children.

Out of Range

If the device connected to the product is out of effective communication range, the communication signal becomes weak and the communication is lost. The effective communication range may vary depending on surrounding and other conditions.

If the device comes back within effective communication range, the product automatically reconnects to the device. If the device is not automatically reconnected, **touch the left or right earbud** once to connect them.

LG TONE Free

If you install the “LG TONE Free” app, you can use Check Earbud Battery, Voice Alert, Change Equalizer Mode, Check Last Connected Location Information, and Find My Earbuds functions. Check out the app for more details.

To install the “LG TONE Free” app, search LG TONE Free in the Google Play Store or App Store or scan the QR code below.

It supports Android 5.0 or higher and iOS 11 or higher.



Google Play



App Store