

Introduction

Thank you for purchasing this Kinetik Labs product. This bracket must be constructed and mounted by a qualified builder or installer. Please keep away from animals and small children as this contains small parts, which could be swallowed.

Description

The KLIB-WB40L bracket is designed for wall mounting Loewe LED and LCD TVs that are fitted with VESA 200 / 300 / 400 mounting points.

Contents

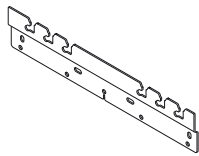

x1

Wall Plate

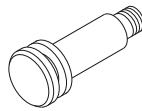

x2

Recess Screen Bolt

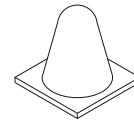

x2

Rubber Wall Rests

Instructions

1.

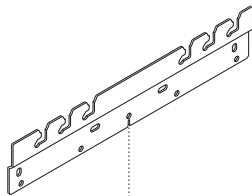

Please note: Wall fixing screws are not included with this bracket. The screw type and size required are dependent on the wall material.

Locate where the screen is to be mounted and, by using the bracket centre point indicated, find the correct positioning for the wall plate.

2.

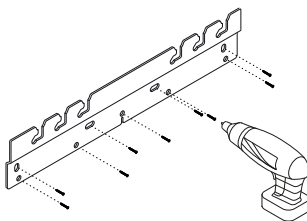

Using suitable screws, attach the wall plate to the surface. There are wider and taller screw holes for horizontal and level adjustment.

3.

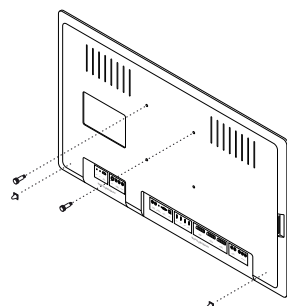

Hand screw the bolts in the top screen mounting holes. Remove the backing from the rubber wall rests and attached them on the rear of the TV near the bottom left and right edges.

4.

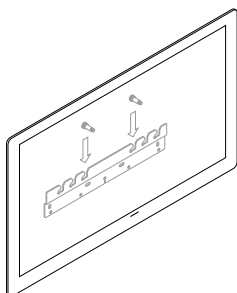

Lower the screen against the bracket as shown and hook the thin section of the bolts into the cut out...

Dimensions / Specifications

KLIB-WB40L Bracket

FRONT

SIDE

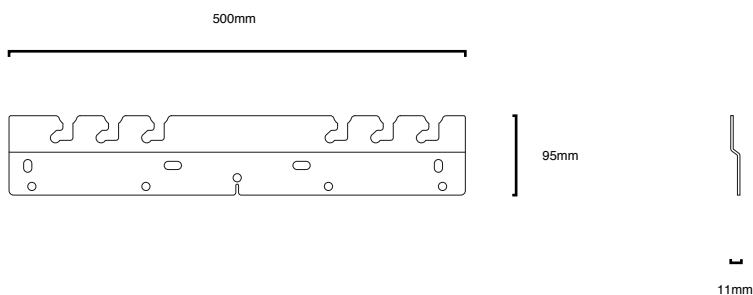

VESA Fixings: 200 / 300 / 400
Maximum Screen Weight: 50kg
Dimensions (H x W x D): 95 x 500 x 11 mm
Packed Weight: 1.3kg

© Copyright AWE Europe Ltd 2012. All rights reserved. Design and specifications are subject to change without prior notice. No part of this document may be reproduced, for any purpose, without prior written permission from AWE Europe Ltd. AWE Europe Ltd is not liable for omissions or for technical or editorial errors herein or for damages directly or indirectly resulting from the use of this Kinetik Labs product. 'Kinetik Labs' and the 'Kinetik' logo are trademarks of AWE Europe Ltd. Made in the UK for Kinetik Labs

